

# Rack-Mounted Energy Storage Battery

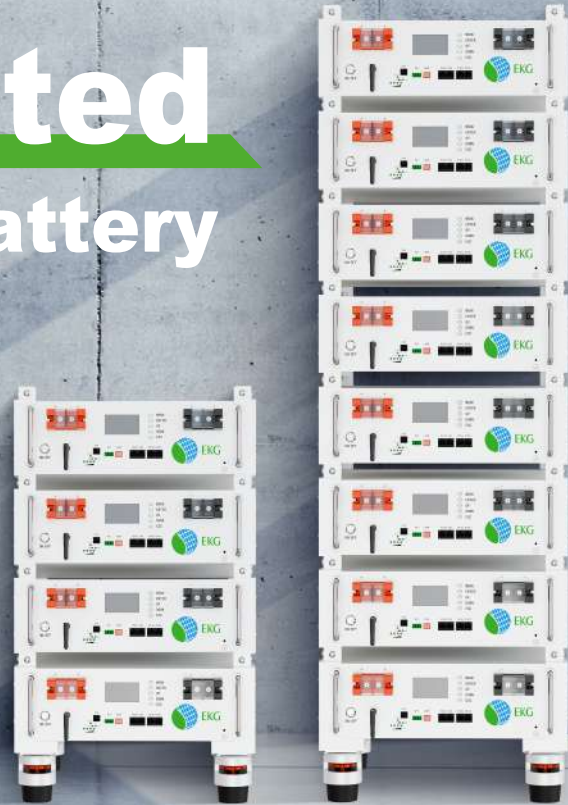

WiFi remote monitoring and cloud management services



## HIGHER EFFICIENCY COMES WITH HIGHER PERFORMANCE



Superior LiFePO4 safety performance



6000 cycles at 80% DOD



1C/1C continual charge and discharge



5 years standard warranty



Low voltage safety connection



Battery Auto-sleep and wake-up upon inverter command

## Compatible with inverter brands

Battery BMS is freely compatible with multiple inverter brands in the market.



ONONE Battery For Multiple Brand Inverters

# Rack-Mounted Energy Storage Battery

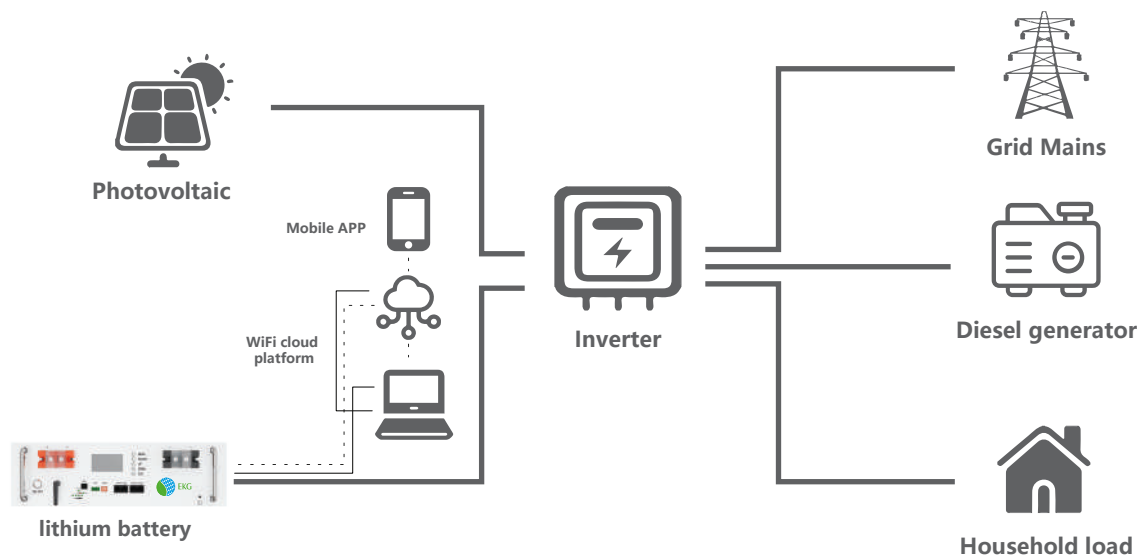

## Parameters

|                             |   |
|-----------------------------|---|
| Nominal Energy              | 5kWh  |
| Nominal Voltage             | 51.2V   |
| Nominal Capacity            | 100Ah   |
| Cell Type                   | LFP   |
| Standard Charge Voltage     | 58.4V   |
| Max Charge Current          | 100A  |
| Discharge Cut-Off Voltage   | 40V   |
| Max Discharge Current       | 100A  |
| Parallel Function           | Support 16 Units In Parallel  |
| Communication Interface     | Inverter: RS485、 CAN ; BMS Monitoring: RS232/USB; Prallels Com. : RS485*2 |
| Calendar Life               | 15+ Years @25°C 80%DOD  |
| Cycle Life *                | ≥6000 Cycles (80%DOD)   |
| Charge temperature range    | 0~65°C  |
| Discharge temperature range | -20~65°C  |
| Certification               | Cell:UL1642 / IEC62619 / CE / ROHS / MSDS /UN38.3<br>Pack: MSDS / UN38.3  |
| Dimensions                  | 440*440*132mm   |
| Weight                      | 41.5Kg  |
| WiFi Function               | yes   |

\*Test Condition: 80% DOD, 0.2C charge & discharge @25°C